

ACADEMIC CITY – FINAL CONCEPT

On July 9, a presentation on the final concept of the master plan for the Academic City developed by the German company gmp International GmbH Architects and Engineers (hereinafter referred to as the Company) was held at the Matenadaran. Tobias Keyl, the Associate Partner of the Company, came to present the current stage of the project, as he did earlier in April this year.

With refined dimensions and locations of various clusters, outlined architectural and infrastructure solutions, and additional directions for preparatory work, the presented master plan of the 580-hectare project, capable of accommodating about 80,000 students, represents the final concept, which has been in development since November last year. Here are some of the key aspects of the presentation conducted by Mr. Keyl.



PURPOSE OF THE ACADEMIC CITY

From the beginning and throughout his speech, Mr. Keyl consistently emphasized that the Academic City, while addressing ambitious goals in the development of Armenian science and education, is, however, a comprehensive project that goes beyond the academic and scientific world and aims to create a comfortable and attractive urban environment for everyone.



«The Academic City is not only a place for students. It should be a human-friendly environment, it should be a hub for cultural exchange, there should be sports, there should be start-up zones, there should be nature. It should be an overall city, as the name “Academic City” already includes. It should include everybody, so not only academics, but also any kind of members of society, including those with disabilities. It is not a place where students go to get lectures and then leave again, but it should be something that is attractive 24-7».

gmp

Vision Et Ambition
Vision

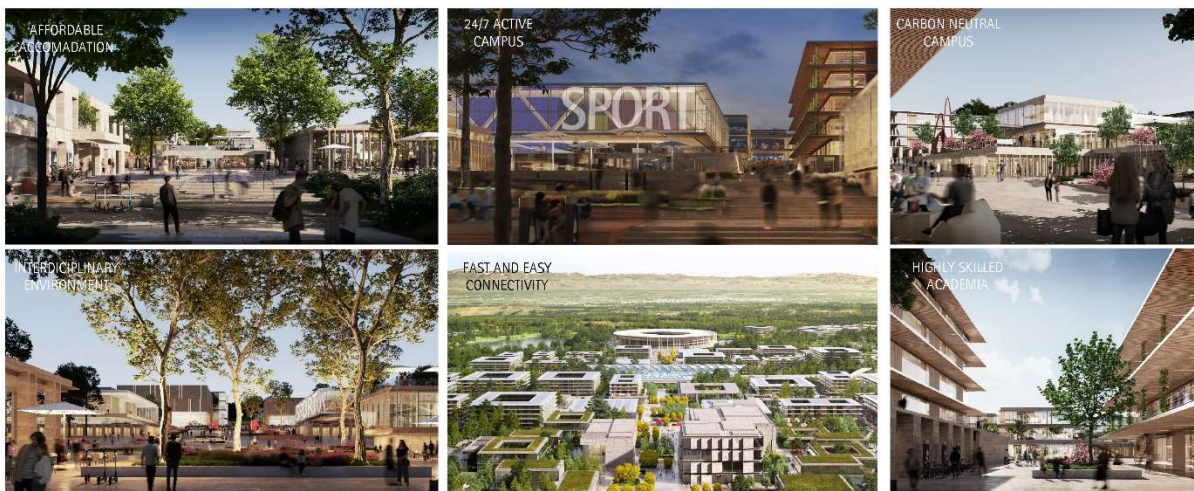

Thus, the Academic City is not just a university campus. It is also a cultural hub, a center for sports development, a home for future startups, a space for leisure and recreation in nature – all this is part of the project's vision.

gmp

Vision & Ambition
Preface



ACADEMIC CITY IS NOT ONLY A UNIVERSITY CAMPUS, BUT ALSO A...

- Human-friendly living neighborhood
- Scientific research lab
- Cultural hub
- Exhibition space
- Sports center
- Start-up zone
- Entertainment district
- Nature park



Academic City: A 24/7 Active Space Hosting Diverse Functions

Therefore, according to Mr. Keyl, before making the Academic City the center of the country's scientific and educational life, it should be formed precisely as a comfortable urban environment, so that students and scientists can comfortably join this place. To this end, the project implementation is divided into five phases, the first of which will be responsible for creating the infrastructure and attractions that will make the Academic City an attractive place to live: Phase 0 will involve improving power lines, working on transport infrastructure, and landscaping, while Phase 1 «will be the main public space, the train station, the cultural cluster, so that there is already something where the public is attracted to, and then comes the academics».

gmp

Construction Sequence
Potential Future Extension

- Potential Future Extension
- Phase IV
- Phase III
- Phase II
- Phase I – Activating the space



gmp

Landuse
Plot Division

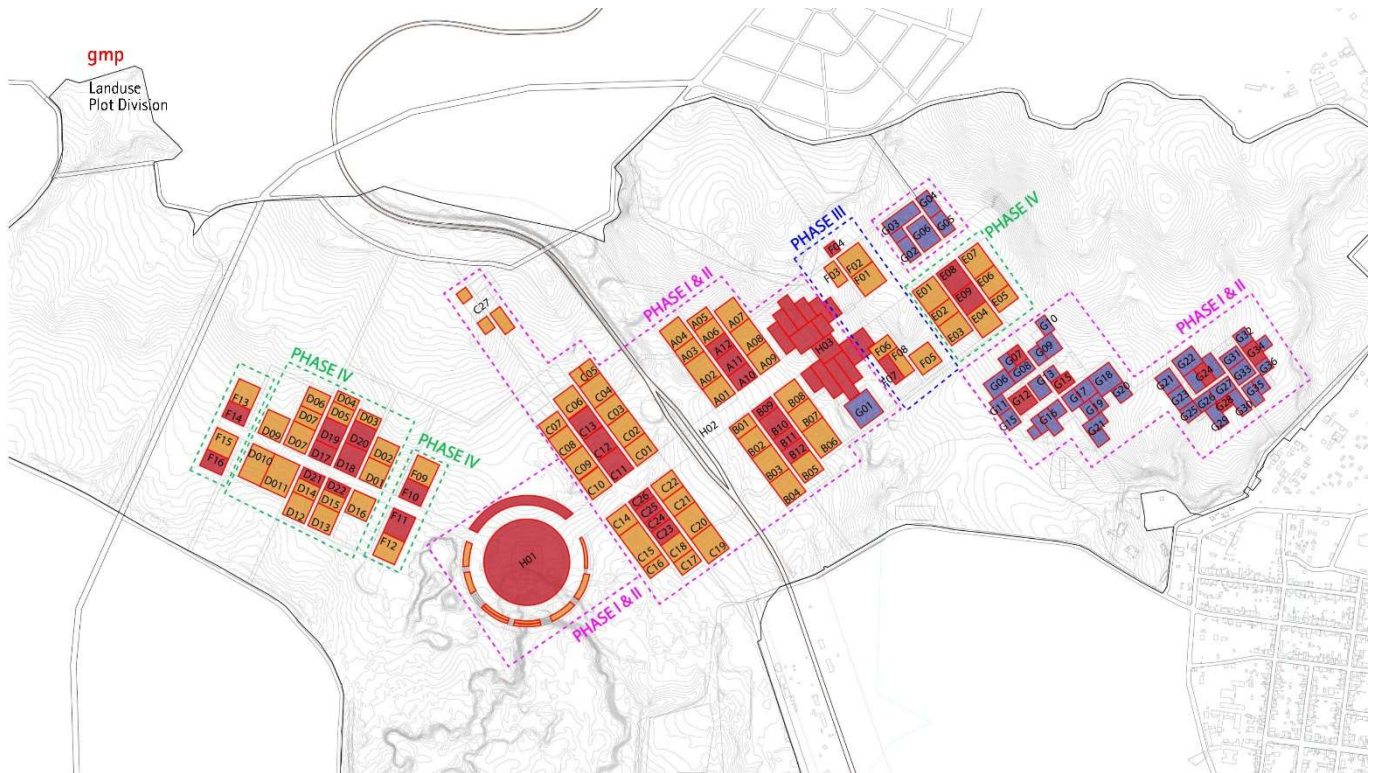

That is why Mr. Keyl's speech paid much attention to specific urban planning topics such as the general plan of the city and its main axis, transport accessibility and pedestrian zones, public spaces, water resources, power lines, thermal regulation, biodiversity, as well as economic aspects such as the sustainability of the city's functioning and the impact of its construction on the

development of the region as a whole.

gmp

Understanding Academic City
Addressing the Site Challenges

Site challenges overview: setting the stage for the Masterplan solutions.

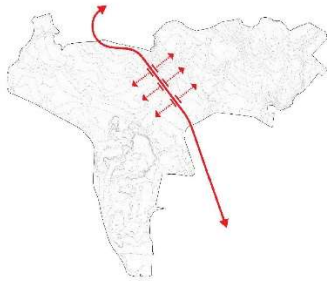

Existing Railway

The operational rail tracks divide the site into two sections, creating a continuous barrier and blocking east-west access.



Irregular Topography

The topography of the site has significant height variations, ranging approximately 170 meters, with irregular slopes in various directions.

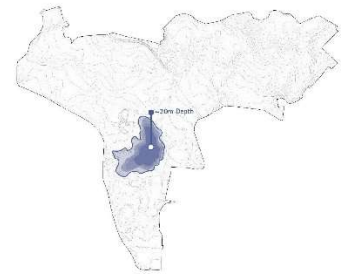

Excavation Pit

The ongoing mining construction has resulted in an excavation depth of 20 meters on the southwest part of the site.

Speaking about the urban planning aspect, Mr. Keyl noted that some decisions, such as the location of university buildings around a «green ring», are attempts to creatively reinterpret Tamanyan's legacy and experience; in general, the city is meant to leave an impression of inheriting Armenian urban planning traditions while introducing students to a new culture of learning and research.

gmp

Masterplan
Design Concept – Dialogue with Yerevan City Center

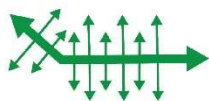
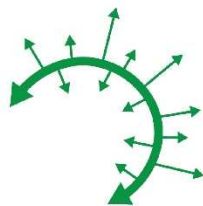

Ultimately, the Academic City should become a place that is not «an expo of fancy architectures, but something that just works and seems natural and does not look old in 30, 40, 50 years». It should be a living, self-sufficient, and efficient city.

CLUSTERS

The designated urban planning initiatives are meant to ensure the realization of the main goal set for the Academic City – to provide students in the country with a space for high-quality education, offering them a new learning environment, a new environment comfortable for research, an environment that will help Armenian universities reach the top of international rankings, increase the influx of foreign students, and generally strengthen the country's internal scientific and educational potential and make it known to the world.

gmp

Vision & Ambition
Preface

4 INTERNATIONAL
RANKING
the top 500 universities



Academic City aims to attract students nationwide by providing a high-quality education and research environment that can compete at an international level. The targets set by the State Program for the Development of Education in the Republic of Armenia until 2030 include:

- Including at least four higher educational institutions in the Top 500 of international rankings.
- Doubling the number of foreign students.

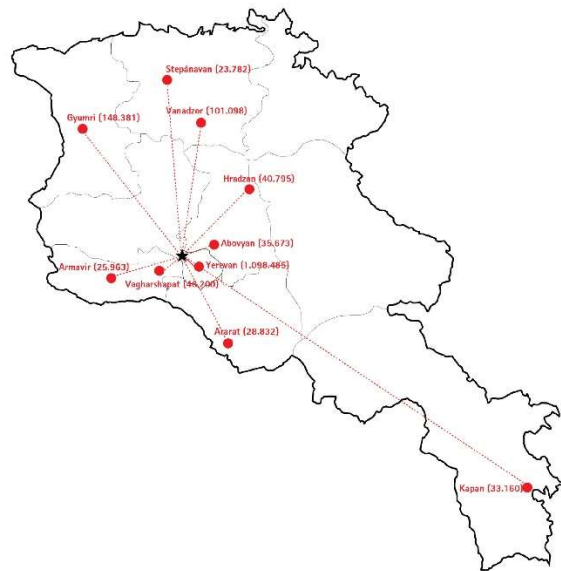

One of the main conditions for the Academic City to be this innovative environment is its interdisciplinary nature. For this purpose, the project provides for the coexistence of different thematic clusters within one space.

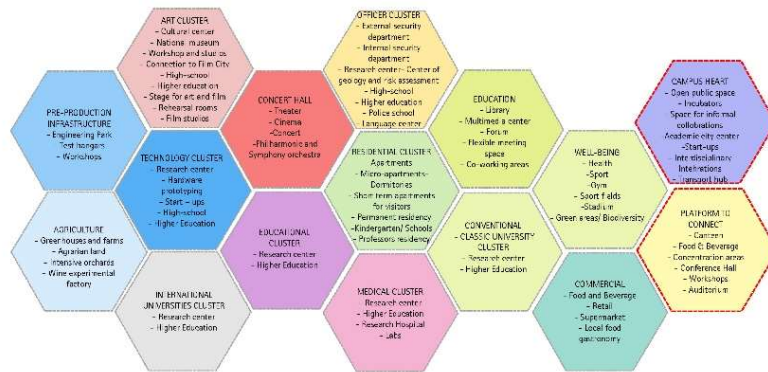

Already at an early stage of discussion, according to Mr. Keyl, «the main idea was that we need a strong link between these different clusters in order to create this interchange, in order to find spaces where people would meet and come together».

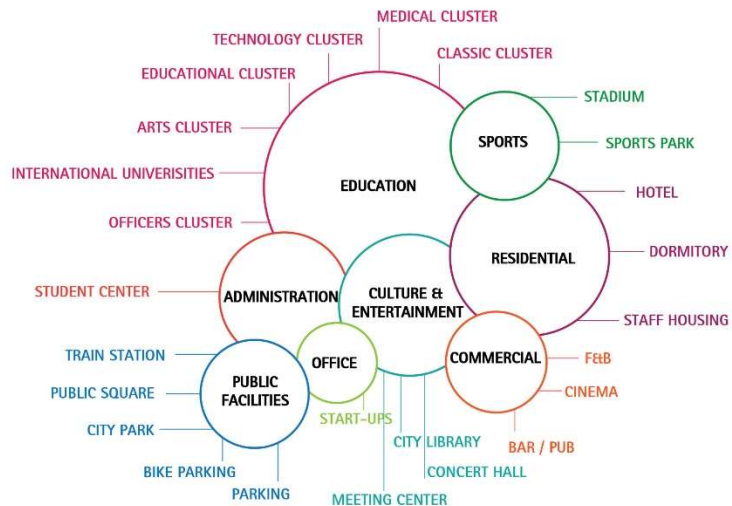

One of the primary vision of Academic City is to cultivate a vibrant 24/7 active campus life that benefits not only students and academic staff but also the wider public.

It aims to serve as a getaway destination from the city center, offering opportunities for nature walks, access to concert halls, fitness facilities, and various forms of intellectual entertainment. Additionally, it provides affordable residential options for both academic staff and students. Academic City serves as a hub for startup companies, aiming to create employment opportunities and foster interdisciplinary collaborations with universities.

Furthermore, with the upcoming national stadium to be situated within the Academic City premises, the campus will also serve as a venue for football events and other sports activities.

Humanities and engineers, medics and military, students of Armenian universities or branches of foreign universities, sports and culture – all this will not only have its self-sufficient corner that will provide each thematic cluster and each educational or research institution with the necessary infrastructure but will also connect with each other in a single interconnected space.

gmp

Masterplan
Character Analysis



Technically, this is implemented through the presence of a central axis in the Academic City, inspired by Tamayan's «green ring», around which most of the clusters are concentrated. Small clusters are located on one side of the axis, large ones on both sides, but all are invariably located to ensure the presence of common spaces, opening clusters to each other and not allowing them to remain isolated.

gmp

Campus Heart
Location

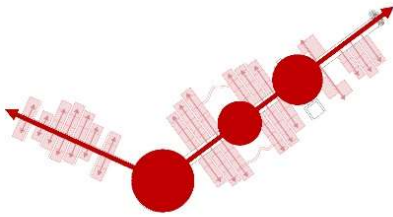

The campus heart as the main public space connecting the academic clusters and the main venues within the Academic City is a dialogue with the Tamanian Plan of 1924 which also gathered the main academic venues and cultural spaces along the green ring. The Campus Heart is similar in width and serves as a connecting open space.

The main axis is envisioned as a green space limited to slow mobility systems. Public plazas generate meeting points for students, professors, lectures as well as the general public. The open space can and should be used for different activities and provide spaces for intellectual entertainment for all.

The topography of the site creates a rising slope towards the culture center from the train station upward. Hence the view from the cultural center back towards the stadium with Mount Ararat in the back will be staged in the best way possible.



«We locate most of the public and semi-public functions directly at this campus heart, so that there's always a public interface, always allowing anyone to engage and enter into these buildings that are along the central axis. We have different positions around the central axis, always creating points of interest, points of spaces for students to meet, but also the general public to enjoy. Each of these clusters has then a sub-center inside, in which we collect the more public functions within the university, such as cafeterias, canteens, bookshops, artist supplies, and any other things that you might need as a student to meet with all the other students within your cluster, but also across».

gmp

Masterplan
Public Space Character

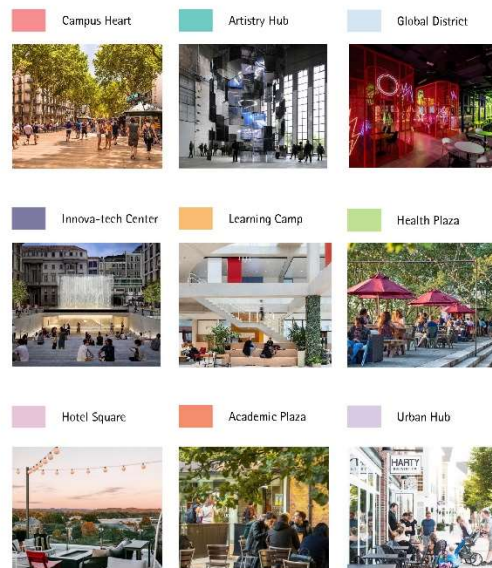
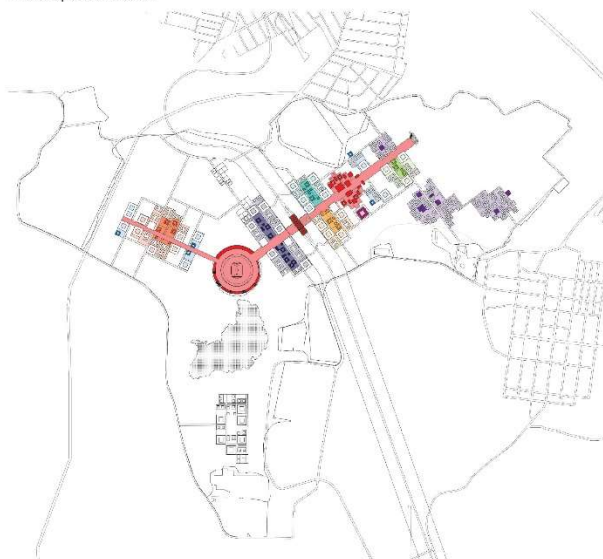

In addition to open spaces and zones in the spirit of Central Park in New York, the intersection points for students and other residents of the Academic City will be a sports stadium and a large cultural cluster, which, being located on a hill, will offer visitors a beautiful view.

gmp

Campus Heart
Section - Highlight Functions

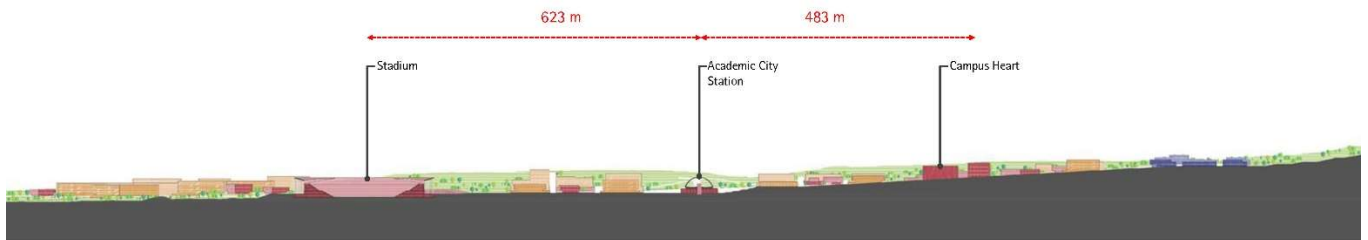

All this will not only ensure an interdisciplinary environment and create a meeting place for students of various directions and specialties but also give them a common experience of interesting leisure, diverse pastime, and simply comfortable living, which, according to the project, will create the microclimate for students and researchers in which the prosperity and progress of Armenian education and science will mature.

SCIENCE AND EDUCATION

The Academic City, with all its innovative infrastructure and cluster division, is designed, as already noted, to help Armenian science and education make a qualitative leap in development. This meets both the specific goals set out in the State Program for the Development of Education in the Republic of Armenia until 2030 (at least a twofold increase in the number of foreign students and at least four Armenian universities in the top 500 international rankings) and the general need to create a new environment and new culture of education and research, increasing the recognition of the Armenian scientific and educational sphere in the world and its attractiveness for students and researchers in Armenia itself.

«Of course, the international recognition of the Armenian academic system is an aim, as well as to produce the highly skilled academia and to keep those that might now leave to other countries to

continue their studies, to keep those in Armenia or re-attract them to come back and relocate. For this, the interdisciplinary environment is important, that people are to exchange ideas, to discuss, and to have this exchange».



University and research buildings will be located in the respective thematic clusters, where they will be surrounded by other auxiliary and infrastructure facilities, making the research and educational process easier, as well as ensuring the connection between the educational and research processes and the economy.

gmp

Landscape Design Enlargement
Educational cluster axonometric



During the presentation, Mr. Keyl touched on some specific solutions related to the interaction of universities and the surrounding infrastructure and the nature of the clusters, for example, the Agricultural University and its use of the fields and other landscape features of the Academic City.

gmp

Understanding Academic City
Program – University Clusters

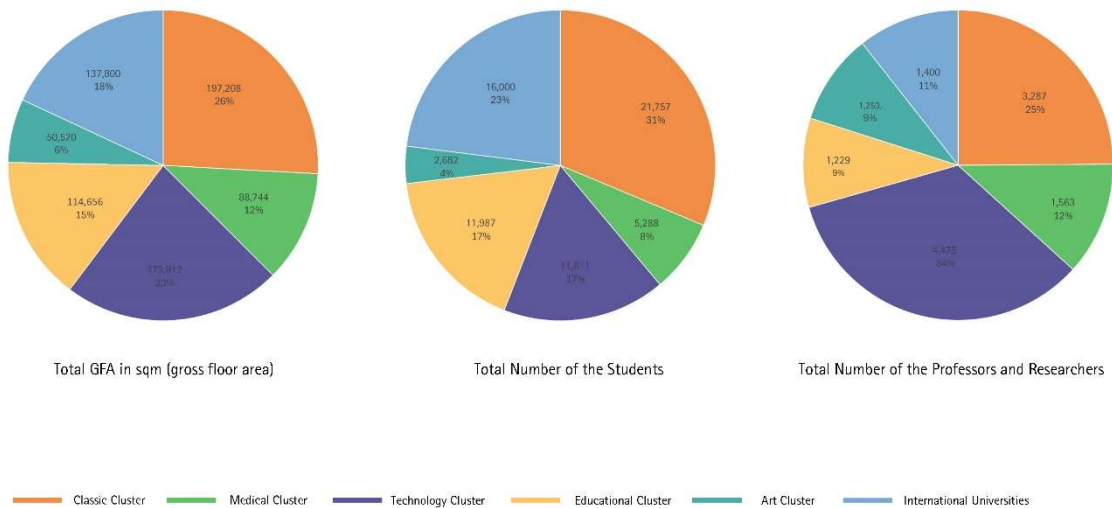

To date, the campus placement projects for all directions are ready and were demonstrated. In addition to domestic universities, a separate cluster will provide space for foreign universities that

will open their branches in the Academic City. However, universities are not just embedded in directive-prepared niches. The Academic City project, according to Mr. Keyl, involves dialogue with the academic environment and identifying their needs: «Depending on phasing, depending on spatial demands and depending on relation to other academic programs around, the universities would be flexible to discuss and find spaces within Academic City».

gmp

Academic Cluster
Educational Cluster Program

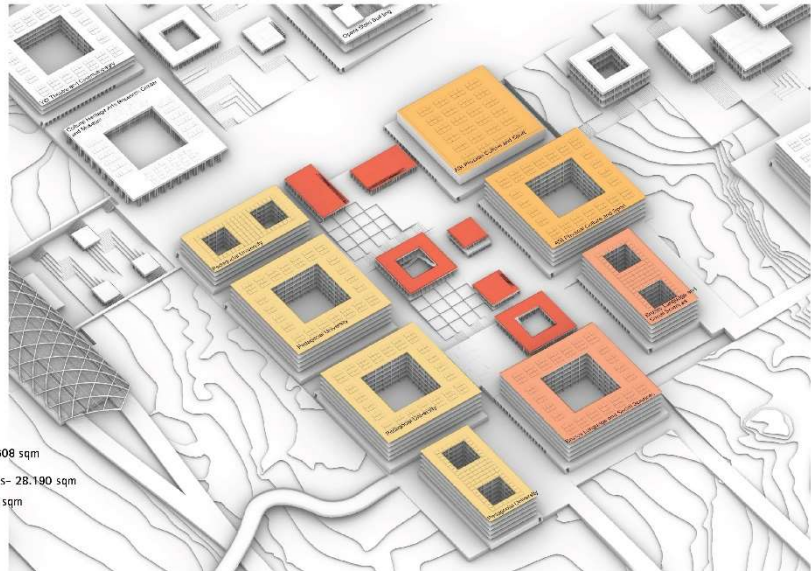
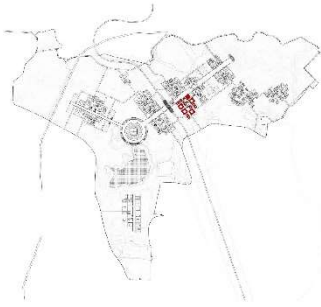

- Khachatur Abovian Armenian State Pedagogical University— 52.608 sqm
- Yerevan Brusov State University of Languages and Social Sciences— 28.190 sqm
- Armenian State Institute of Physical Culture and Sport – 30.712 sqm
- Shared facilities – 5.569 sqm

TOTAL: 111.510 sqm + Shared Facilities

gmp

Academic Cluster
Technology Cluster Program - 01

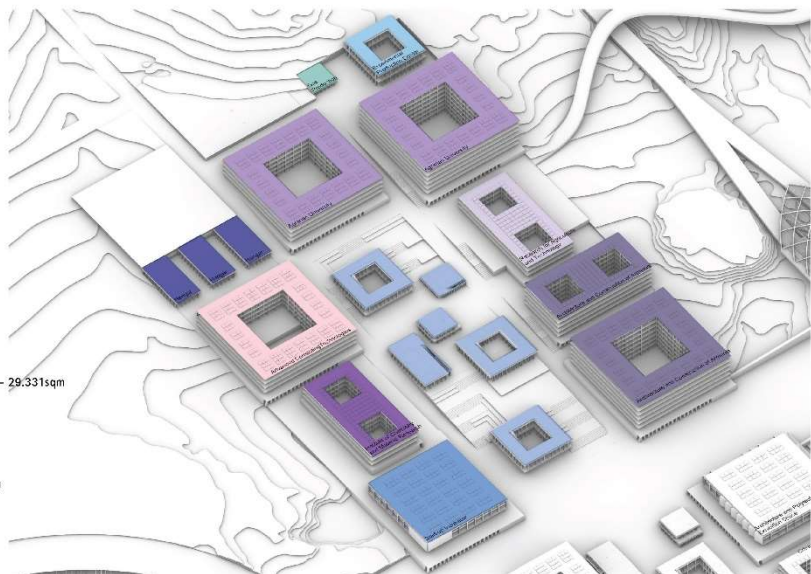
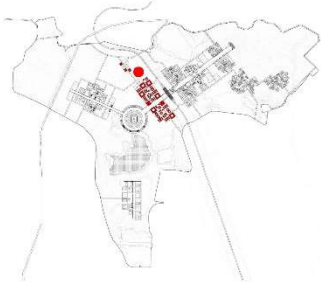

- Armenian National Agrarian University— 34.783 sqm
- National University of Architecture and Construction of Armenia— 29.331sqm
- Research Center for Agriculture and Technology— 6.290 sqm
- Advanced Computing Technologies
Et Advanced Prototyping Et Technology Facilities – 14.659 sqm
- Institute of Chemistry and Material Research— 6.290 sqm
- Experimental Production Center (Separate Building) – 1.944 sqm
- Gas Production Center (Separate Building)— 324 sqm
- 3 x Hangars Total (Separate Building)— 1.943 sqm
- Startup Incubator— 10.700 sqm
- Shared facilities – 6.978 sqm

gmp

Academic Cluster
Technology Cluster Program - 02

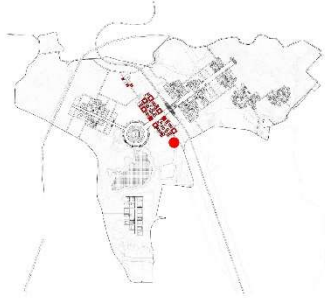

- National Polytechnic University of Armenia— 56.572 sqm
- Criminology and Forensics Research Center
Et Geology and Risk Assessment Center – 6.290 sqm
- Physics Research Center— 6.290 sqm
- Highschool— 4.240 sqm
- Architecture and Polytechic Library and Exhibition Space – 14.710 sqm
- Shared facilities – 4.229 sqm

TOTAL: 173.286 sqm + Polytechic Library + Shared Facilities

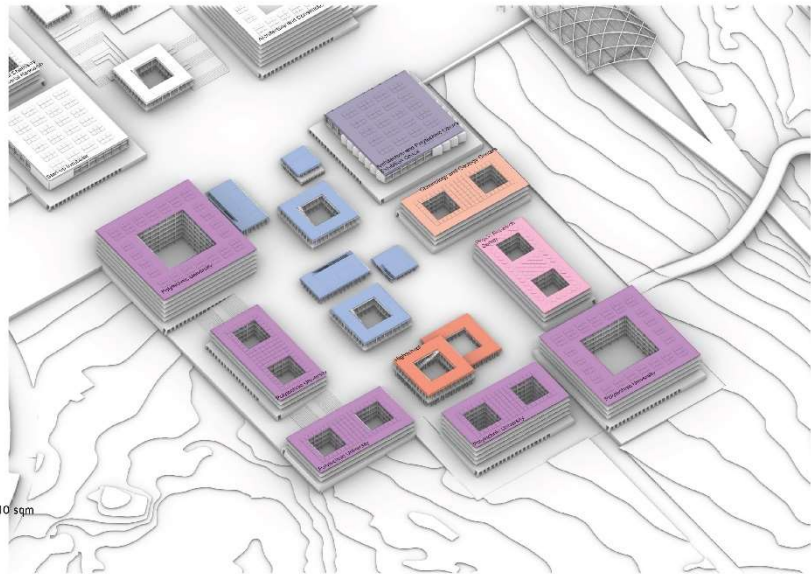

gmp

Academic Cluster
Medical Cluster Program

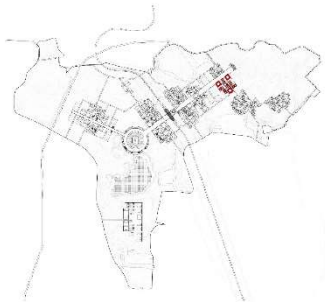

- Yerevan State Medical University— 53.200 sqm
- Hospital— 26.414 sqm
- Life Sciences Research Institute— 6.290 sqm
- Shared facilities – 4.778 sqm

TOTAL: 85.904 sqm + Shared Facilities

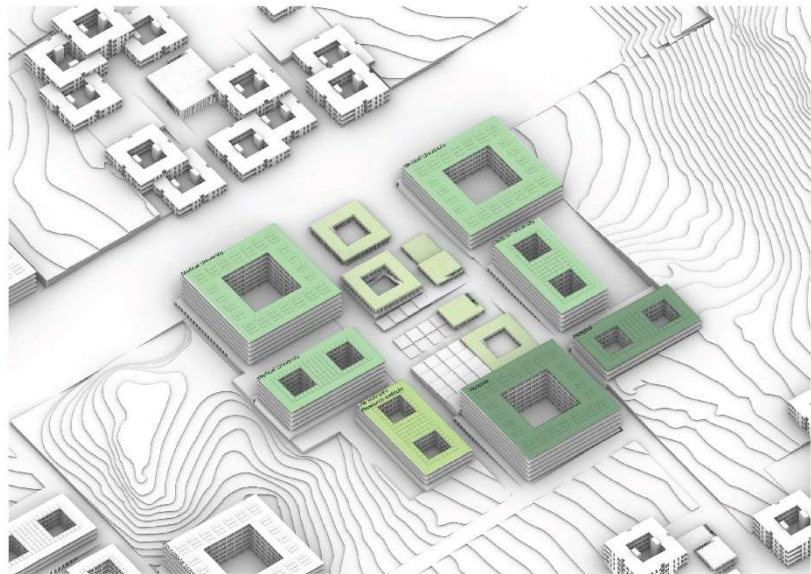

gmp

Academic Cluster
Classic Cluster Program

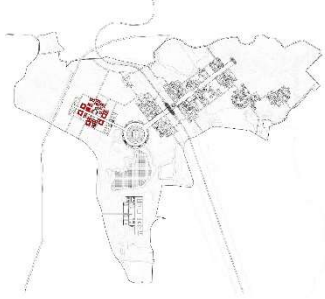

- Yerevan State University— 130.075 sqm
- Armenian State University of Economics— 49.280 sqm
- Public Administration Academy of the Republic of Armenia— 6.896 sqm
- Social Sciences and Humanities Research Center
 & Physics Research Institute
 & Zoology Research Institute
 & Biotech Research Institute— 12.751 sqm
- "Armbiotechnology" Scientific and Production Center (SNCO)— 1.548 sqm
- Highschool— 6.896 sqm
- Shared facilities — 10.042 sqm

TOTAL: 207,446 sqm + Shared Facilities

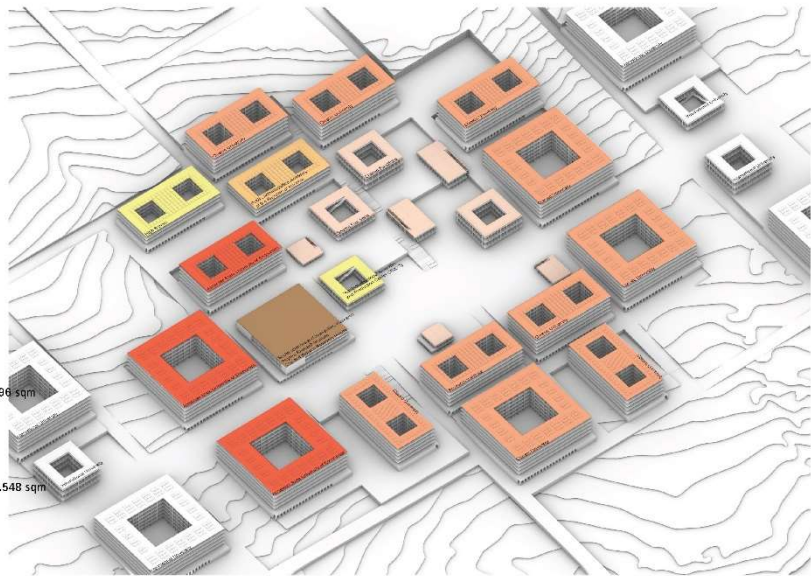

gmp

Academic Cluster
International Cluster Program

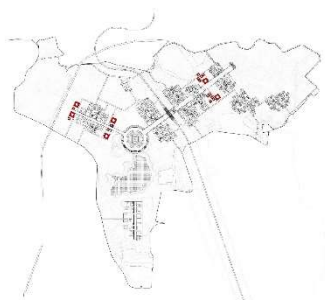

Each international university cluster consists of two international universities.
Academic City hosts a total of 8 international universities, located in four different locations of the site.

- International University— 17.391 sqm each
- International University— 17.391 sqm each
- Shared facilities — 1944 sqm each

TOTAL: 140,728 sqm + Shared Facilities

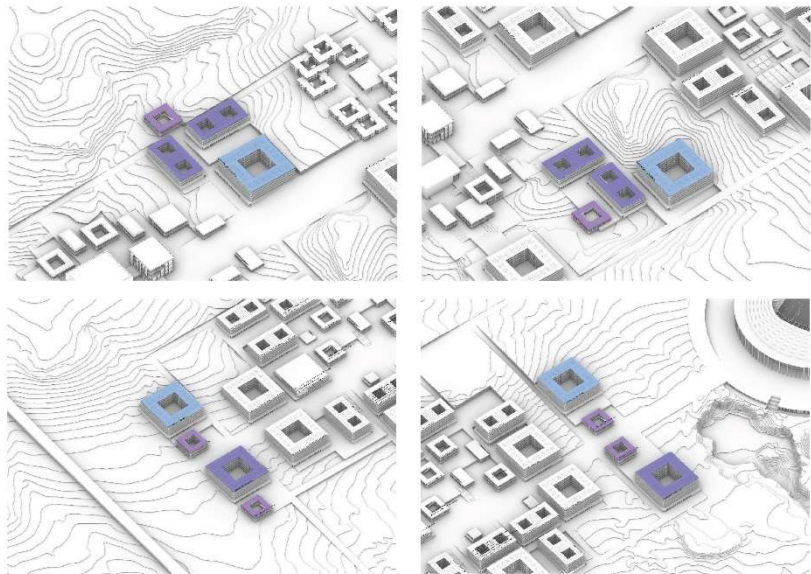

gmp

Academic Cluster
Art Cluster Program

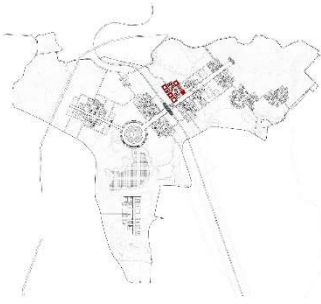

- Opera Studio Building with Orchestra Pit - TBD
- Komitas State Conservatory of Yerevan - 18.218 sqm
- State Academy of Fine Arts of Armenia - Institute of Archaeology and Ethnography - 19.677 sqm
- Yerevan State Institute of Theatre and Cinematography - 11.927 sqm
- Cultural Heritage and Arts Research Center and Museum - 3.628 sqm
- Repository Research Institute + Hangar - 6.290 sqm
- Highschool - 1.872 sqm
- Shared facilities - 3.415 sqm

TOTAL: 61.612 sqm + Opera Studio + Shared Facilities

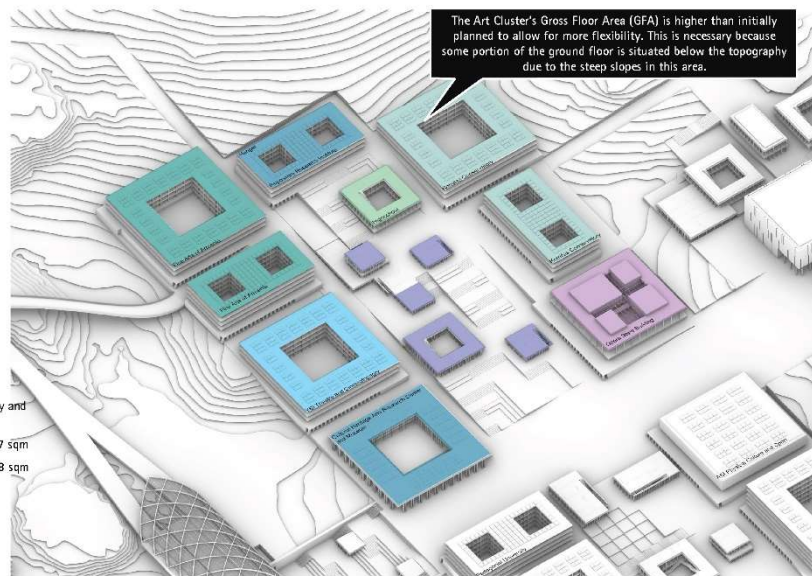

Being not only a university and research campus but also a city, the Academic City will also be a home for both students and teachers and researchers. «There will be living areas for students as well as teachers and a hotel. They are located off to the east, connecting with the existing infrastructures of residential services that are there already, and they're designed in clusters of different size. They all sit within their own green spaces. They foster social interaction and blend this life of a student between studying and private time, study time, and very attractive environments. We have canteens to provide breakfast, lunch, and dinner, but also smaller shops, cafes, and spaces for students to meet and exchange. This is sort of the little student village sitting within this green environment».

In total, the Academic City will be able to accommodate about 80,000 students.

gmp

Living Quarters
Dormitory Massing Strategy

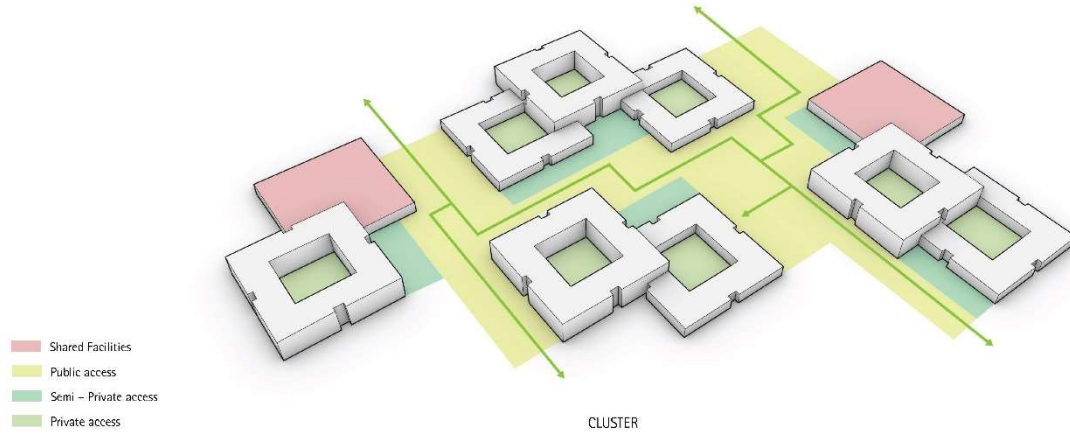

gmp

Living Quarters
Subdivision of Main Functions

